

KAAO

COLONEL JAMES JABARA AIRPORT

- **Frequencies:**
 - CTAF: 122.7
 - ASOS: 134.025 (316-636-2541)
 - Wichita Approach/Departure: 134.8
 - Clearance Delivery: 125.0
- **VORs**
 - ICT 113.8
 - HUT 116.8
- **Noise sensitive areas**
 - NOISE SENSITIVE AREAS TO THE SOUTH & WEST

- **PILOT CONTROLLED LIGHTING**
 - CTAF: 122.7
 - RUNWAY
 - TAXIWAYS
 - APCH LIGHTING SYSTEM
 - REIL
- **PAPI:**
 - CONTINUOUSLY ON

BE ALERT FOR MILITARY AIRCRAFT AT AND ABOVE 3,000 FEET MSL

TRAFFIC PATTERN WEST SIDE ALTITUDE 2,400 FEET MSL

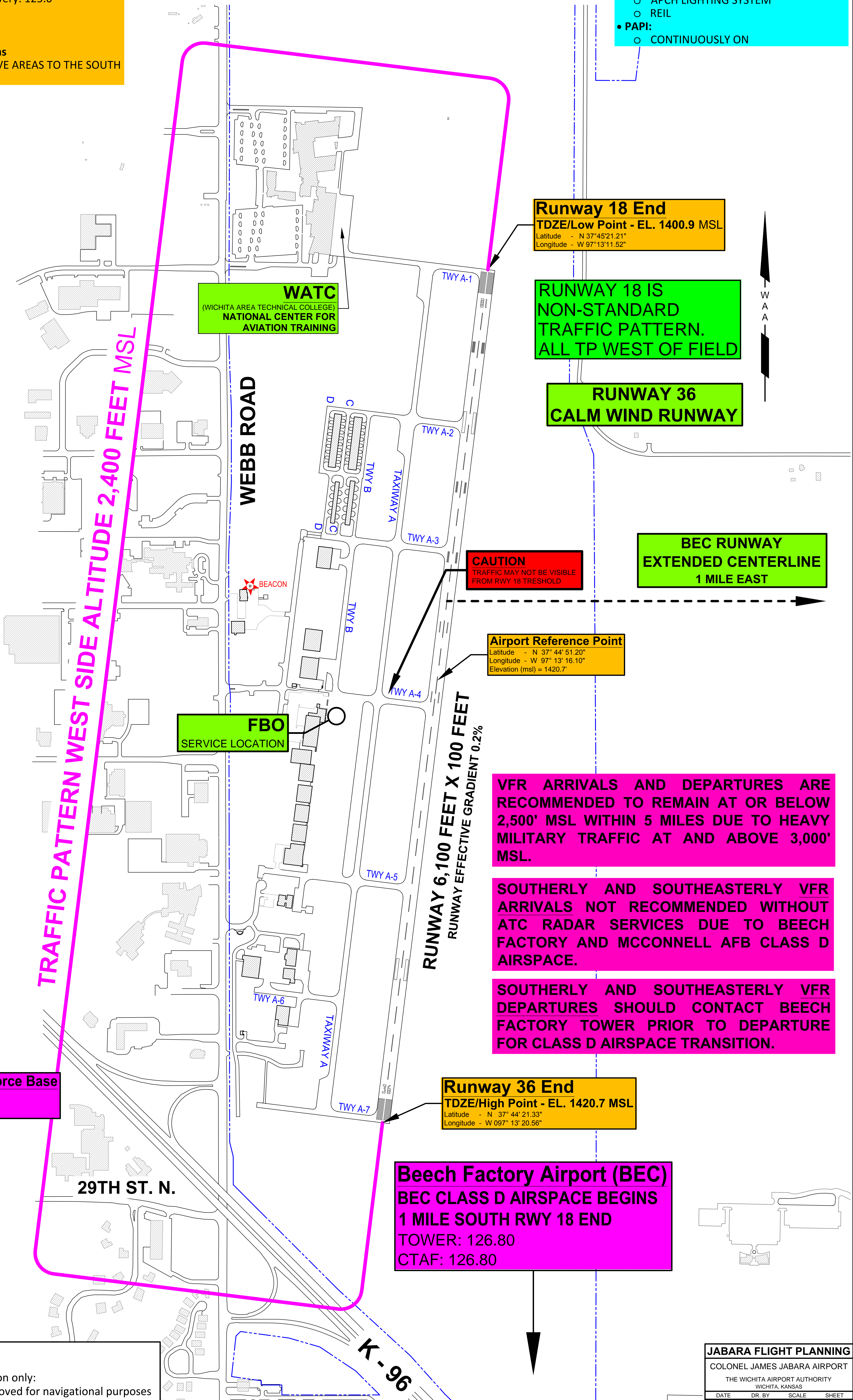

Runway 18 End
 TDZE/Low Point - EL. 1400.9 MSL
 Latitude - N 37°45'21.21"
 Longitude - W 97°13'11.52"

RUNWAY 18 IS NON-STANDARD TRAFFIC PATTERN. ALL TP WEST OF FIELD

RUNWAY 36 CALM WIND RUNWAY

BEC RUNWAY EXTENDED CENTERLINE 1 MILE EAST

CAUTION
 TRAFFIC MAY NOT BE VISIBLE FROM RWY 18 THRESHOLD

Airport Reference Point
 Latitude - N 37° 44' 51.20"
 Longitude - W 97° 13' 16.10"
 Elevation (msl) = 1420.7'

RUNWAY 6,100 FEET X 100 FEET
 RUNWAY EFFECTIVE GRADIENT 0.2%

VFR ARRIVALS AND DEPARTURES ARE RECOMMENDED TO REMAIN AT OR BELOW 2,500' MSL WITHIN 5 MILES DUE TO HEAVY MILITARY TRAFFIC AT AND ABOVE 3,000' MSL.

SOUTHERLY AND SOUTHEASTERLY VFR ARRIVALS NOT RECOMMENDED WITHOUT ATC RADAR SERVICES DUE TO BEECH FACTORY AND MCCONNELL AFB CLASS D AIRSPACE.

SOUTHERLY AND SOUTHEASTERLY VFR DEPARTURES SHOULD CONTACT BEECH FACTORY TOWER PRIOR TO DEPARTURE FOR CLASS D AIRSPACE TRANSITION.

McConnell Air Force Base
 TOWER: 127.25
 9 MILES SOUTH

Runway 36 End
 TDZE/High Point - EL. 1420.7 MSL
 Latitude - N 37° 44' 21.33"
 Longitude - W 097° 13' 20.56"

Beech Factory Airport (BEC)
BEC CLASS D AIRSPACE BEGINS 1 MILE SOUTH RWY 18 END
 TOWER: 126.80
 CTAF: 126.80

Disclaimer:
 For general information only:
 This map is NOT Approved for navigational purposes